

KEY:

- A. - EXTANT PLSS CORNER NOTED. FOUND 3-1/4" ALUMINUM CAPPED, 3/4" REBAR STAMPED PLS 25971, 2003.
- B. - FOUND PLASTIC CAPPED REBAR STAMPED PLS 2487, APPARENT ORIGINAL MONUMENT.
- C. - SET ALUMINUM CAPPED, 1/2" REBAR STAMPED PLS 25971.
- D. - FOUND PLASTIC CAPPED, 1/2" REBAR STAMPED PLS 25971.
- F. - FOUND 5/8" REBAR.
- G. - CHISLED A CROSS "+" IN BOULDER.

NOTICE:

1. For title, reference to a title insurance policy is recommended.
2. Wetlands are not addressed.
3. This document is certified as one, complete document. Any alteration, addition, change or edit of any part of this document supercedes and invalidates all previous information and certifications.
4. This plat corrects an erroneous distance of 127.07 for the west boundary, to a distance of 122.07 as platted.
6. Applicable setbacks are determined either by the Town, HOA or County with jurisdiction over development of this property.
7. The original plat contains a distance along the north boundary that appears to be in error. This surveyor could find no original monumentation along the curved eastern boundary. What is shown and monumented hereon is a best fit approach to a solution.

This topographic survey shows the result of a field survey done by me or under my responsible charge based on facts known to me, and is not a warranty or guarantee, either expressed or implied.

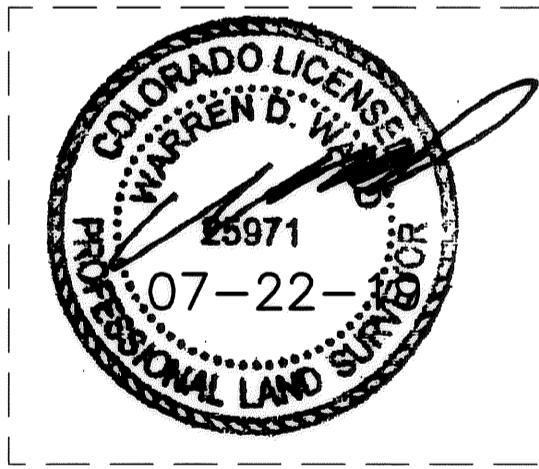

LS2270

<p>CORRECTION PLAT 84 Timber Drive A Retracement Survey of Lot 34, Hideaway Village South, Filing 2 Part of Sec. 33 T1S, R75W, 6TH PM Town of Winter Park, Grand County, Colorado</p>		<p>STATE OF COLORADO } SS County of GRAND } Filed for record this <u>23rd</u> day of <u>July</u>, 2019 at <u>1:56</u> o'clock <u>P.</u>M. Recorded in Book _____ Page _____ <i>Sara L. Rosene</i> Recorder <i>Doreen White</i> Deputy Fees \$ <u>20.00</u></p>
<p>SCALE: 1 IN = 10 USFT by ww JN A17-08</p>		
<p>DATE: 07-11-18, 07-22-19</p>		